







# Seco 595-610W

High efficiency monofacial modules

**PERC**

**210mm**

• **PERC MODULE ADVANTAGE**

-  Less mismatch to get more power
-  Less power loss by minimizing the shading impact
-  Excellent low-light performance
-  Low BOS and LCOE
-  3 times EL test to ensure best quality
-  Superior load capacity 2400 Pa wind load & 5400 Pa snow load

• **QUALITY SYSTEM**

ISO9001 / ISO14001 / ISO45001

• **PRODUCT CERTIFICATION**



• **INSURANCE**

**PICC**

• **WARRANTY**

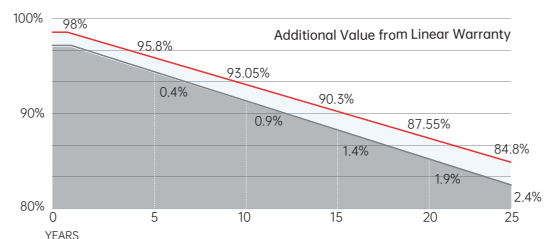

**15 YEARS** Guarantee on product material and workmanship

**25 YEARS** Linear power output warranty



**SERAPHIM ENERGY GROUP CO., LTD.**

Add: NO.18, Shichuan Road, Jinzhai Economic Development Zone, Lu'an City, Anhui Province  
 Tel: +86-564-7736177 Email: info@seraphim-energy.com

## Electrical Characteristics

Module Type	SRP-595-BMB-HV		SRP-600-BMB-HV		SRP-605-BMB-HV		SRP-610-BMB-HV	
	STC	NOCT	STC	NOCT	STC	NOCT	STC	NOCT
Maximum Power at STC (Pmp)	595	446	600	450	605	454	610	458
Open Circuit Voltage (Voc)	41.49	39.42	41.69	39.61	41.89	39.80	42.09	39.99
Short Circuit Current (Isc)	18.34	14.67	18.40	14.72	18.46	14.77	18.52	14.82
Maximum Power Voltage (Vmp)	34.38	32.22	34.58	32.40	34.78	32.58	34.98	32.75
Maximum Power Current (Imp)	17.31	13.85	17.36	13.89	17.41	13.93	17.46	13.97
Module Efficiency at STC(ηm)	21.02		21.20		21.38		21.55	
Power Tolerance(W)	(0, +4.99)							
Maximum System Voltage	1500V DC							
Maximum Series Fuse Rating	30 A							

STC: Irradiance 1000 W/m<sup>2</sup> module temperature 25°C AM=1.5  
Power measurement tolerance: +/-3%

## Temperature Characteristics

Pmax Temperature Coefficient	-0.34 %/°C
Voc Temperature Coefficient	-0.25 %/°C
Isc Temperature Coefficient	+0.04 %/°C
Operating Temperature	-40 ~ +85 °C
Nominal Operating Cell Temperature(NOCT)	45±2 °C

## Mechanical Specifications

External Dimensions	2172 x 1303 x 33 mm
Weight	29.5 kg
Solar Cells	PERC Mono (120pcs)
Front Glass	3.2mm AR coating tempered glass, low iron
Frame	Anodized aluminium alloy
Junction Box	IP68, 3 diodes
Output Cables	4.0mm <sup>2</sup> , 250mm(+)/350mm(-) or Customized Length
Mechanical Load	Front side 5400Pa/ Rear side 2400Pa

## Packing Configuration

	2172 x 1303 x 33 mm
Container	40'HQ
Pieces per Pallet	33
Pallets per Container	18
Pieces per Container	594

For details, please consult SERAPHIM.

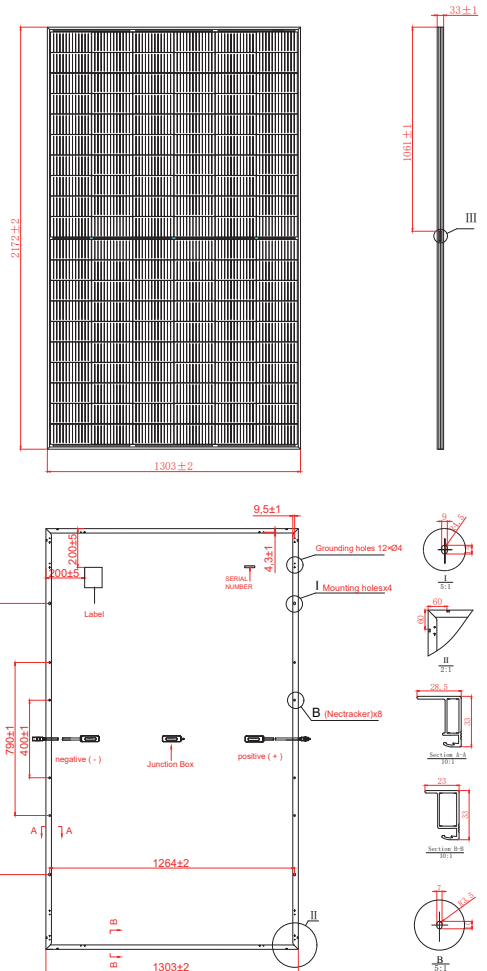

## I-V Curve

